

NOTES:

1. ALL CONNECTIONS TO BE COMPRESSION TYPE.
2. MATERIAL USED SHALL BE AS SPECIFIED OR AN APPROVED EQUAL.
3. ALL SERVICE WYES & EXTENSIONS ARE TO BE INSTALLED WITH THE MAIN LINE CONSTRUCTION.
4. EXISTING METER BOXES ARE TO BE REMOVED. THE NEW METER BOXES SHALL BE OLD CASTLE.
5. ANGLE STOPS MAY BE USED FOR NEW CONSTRUCTION IF FINISHED ELEVATION IS KNOWN. THE STOP MUST BE INSTALLED 10"-12" BELOW THE FINISHED ELEVATION.

METER NUT SIZE	FORD PART NO.
3/4" x 2.5" Long	C38-23-2-5
3/4" x 3" Long	C38-23-3
3/4" x 12" Long	C38-23-12
1" x 2.625" Long	C38-44-2-625
1" x 8.5" Long	C38-44-8-5
1-1/2" Meter Nipple	C38-66-2-875
1-1/2" Meter Bushing	BBIM-66
2" Meter Nipple	C38-77
2" Meter Bushing	BBIM-77

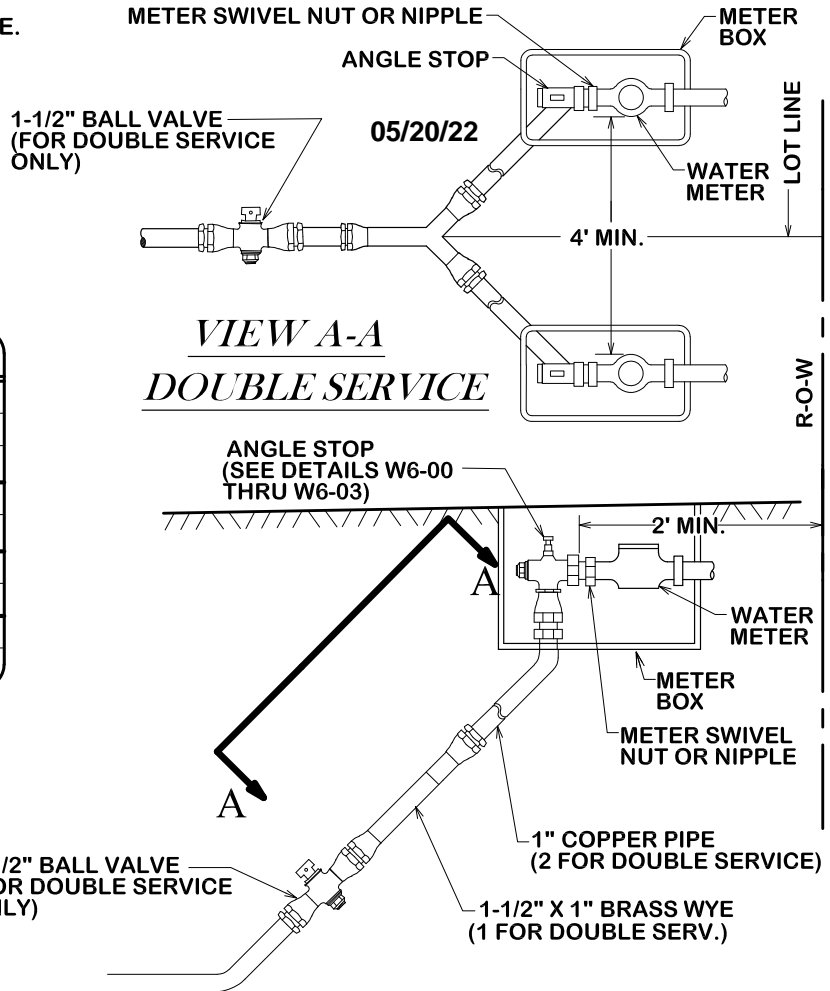

**CITY OF BRYAN
WATER SERVICE RECONNECTION**

DATE
FEB 2021

**B/CS UNIFIED
STANDARD DETAIL**

DETAIL NO.
W6-04

