

**NOTE:**  
 MIN. 18" TOE WALL TO BE CONSTRUCTED  
 AT BEGINNING & END OF CONCRETE  
 DITCH CHANNEL & RIP-RAP SECTIONS.

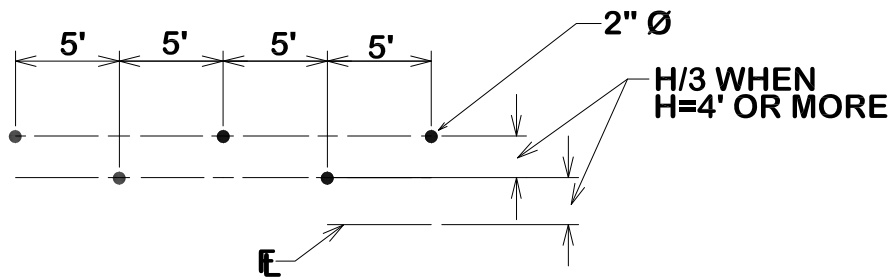

***WEEP HOLE DETAIL***

**28-DAY CONCRETE STRENGTH = 3000 psi**



**CITY OF BRYAN**  
*The Good Life, Texas Style.*

**CONCRETE CHANNEL LINING**

DATE  
**DECEMBER 2020**

**B/C'S UNIFIED  
 STANDARD DETAIL**

DETAIL NO.  
**D2-00**



**CITY OF COLLEGE STATION**